

This box contains:

Codec C90

Top tray

TRC V remote control

- A. Rack profiles (2 pcs)
- B. Rack rear brackets (2 pcs)
- C. Rack extension brackets (2 pcs)
- D. Rack ear profiles left/right (2 pcs)

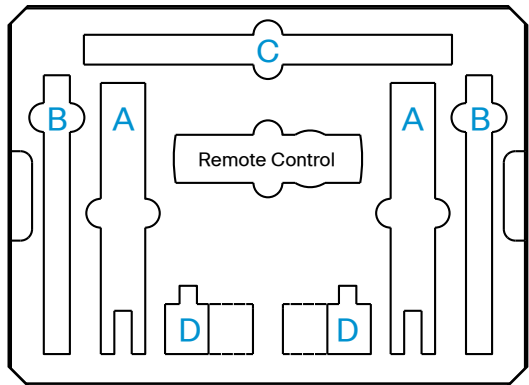

Accessories box and cable kit

- HDMI cable (3 m / 10 ft)
- Ethernet cable (5 m / 16 ft)
- Power cable (1.8 m / 6 ft)
- Batteries LR03 AAA 1.5 V for the remote control
- Screwdriver, combi 2 mm / 4 mm Allen Key (unbraco)
- Screws (M6 and M3) and cage nuts (M6)
- Universal rack brackets*

* Universal rack brackets: Use these only if the supplied rail based rack mounting kit does not fit your type of rack.

User guides

The user documentation for this product, including compliance and safety information, is available on the Cisco web site. Go to: <http://www.cisco.com/go/telepresence/docs>.

Rack mounting

WARRANTY: Rack mounting the codec without using the supplied mounting kit will void the warranty.



Please follow the steps in this installation guide when rack mounting the codec.

TIP

If the menu is not already present, press Home key or OK key on the remote control to open the menu. Navigate in the menu with the arrow keys.



Rack mounting and connecting cables

1 Assembling the rack profiles

Slide the rack profiles A and B together.

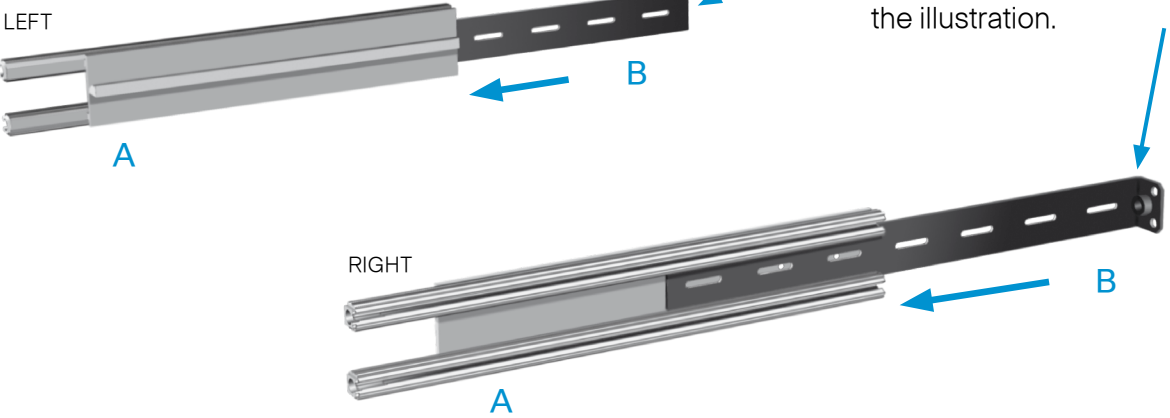

NOTE: The profile should be assembled with the bend in the direction as shown in the illustration.

2 Optional: Assembling the extension rails

If the rack is deeper than the length of the rack profiles A+B, then the extension rails C are needed.

Mount the extension rail (C) to the rack profiles (A+B) using M6 screws.
Tool: Screwdriver, 4 mm Allen Key

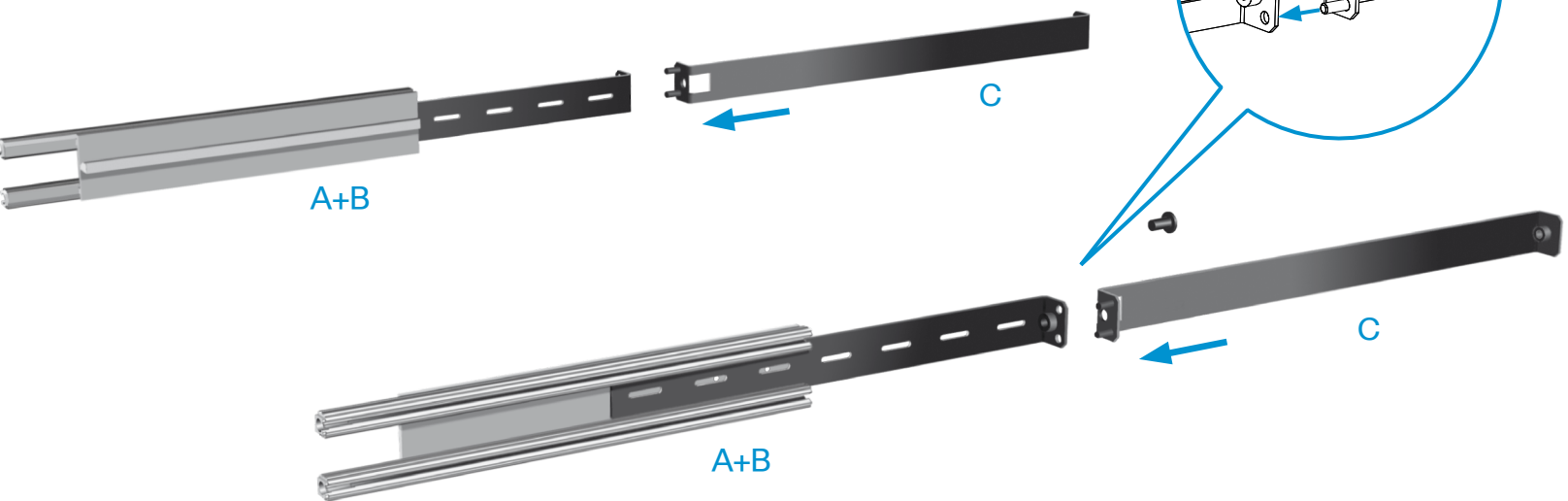

3 Mounting the rack profiles to the rack

Mount the left and right rack profiles A+B(+C) to the rack. The screws, screwdriver and cage nuts are found in the accessories box.

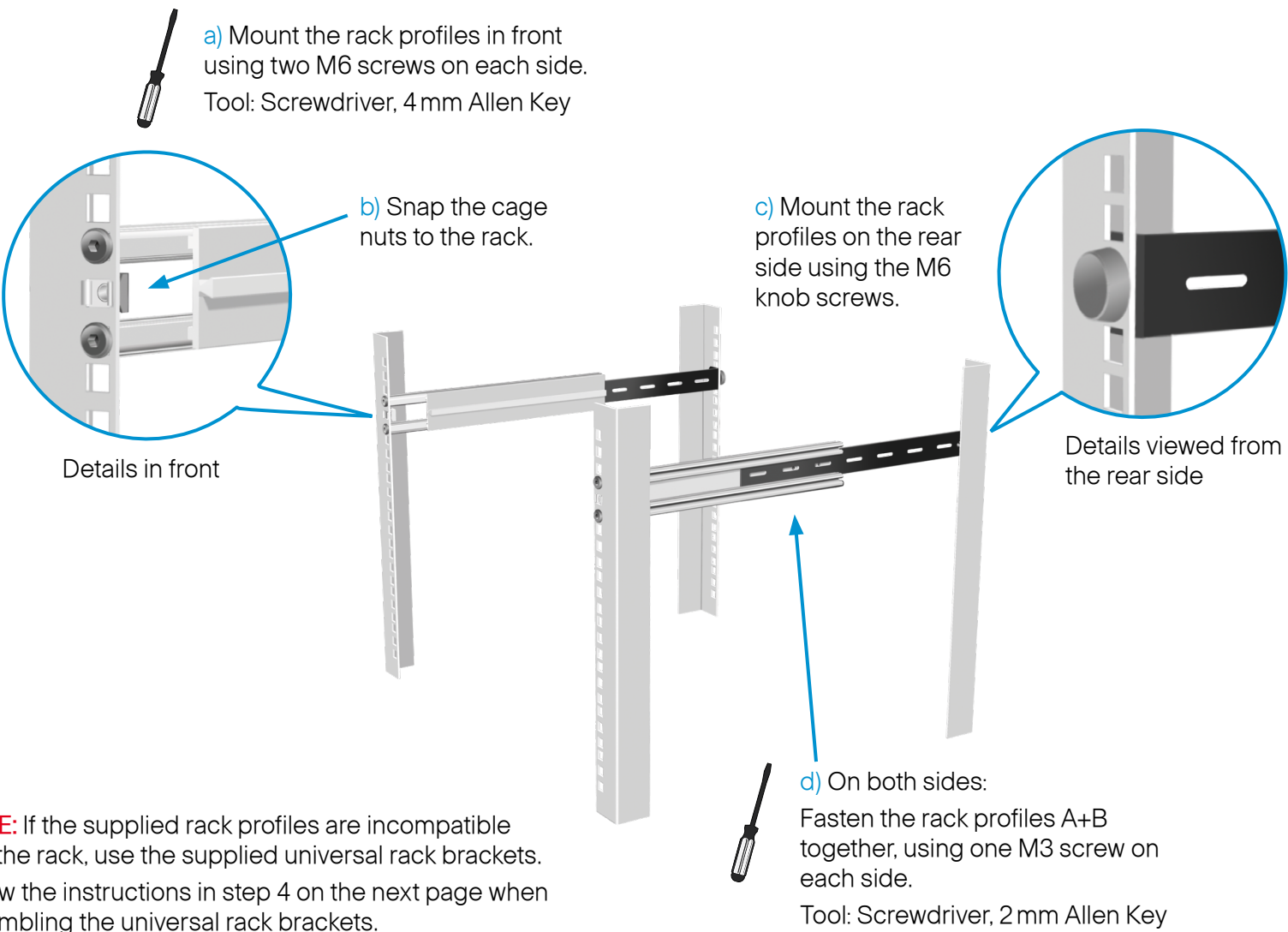

NOTE: If the supplied rack profiles are incompatible with the rack, use the supplied universal rack brackets. Follow the instructions in step 4 on the next page when assembling the universal rack brackets.

4 Assembling the rack ear profiles

Mount the left and right rack ear profiles to the codec.

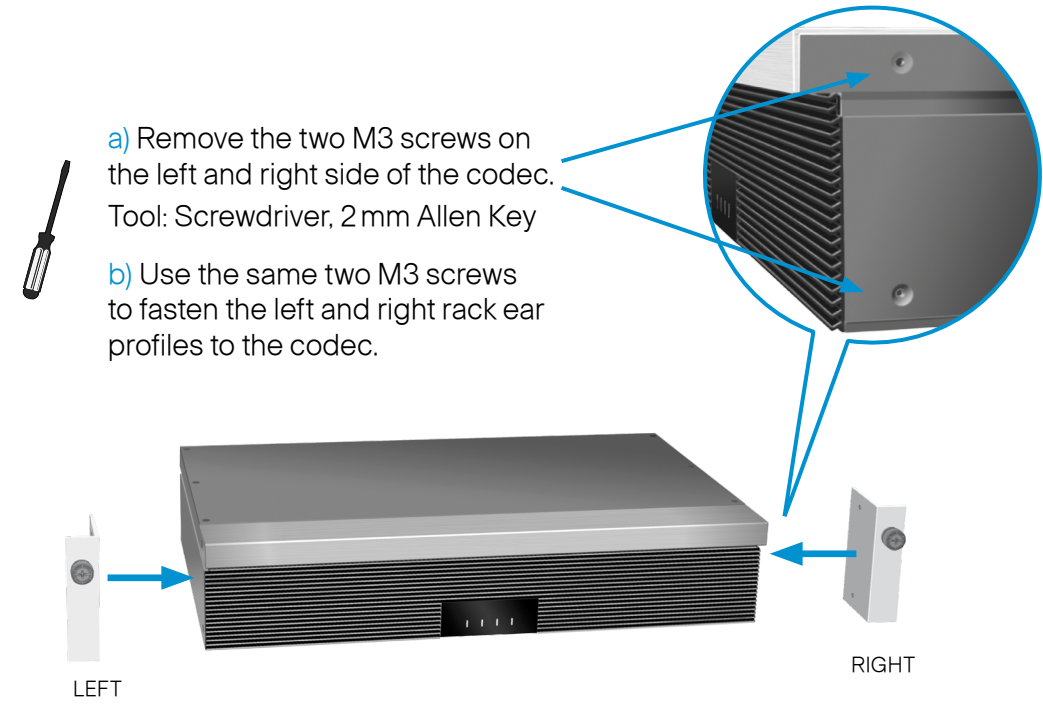

5 Mounting the codec onto the rack

Locate the rails and carefully slide the codec onto the rack.

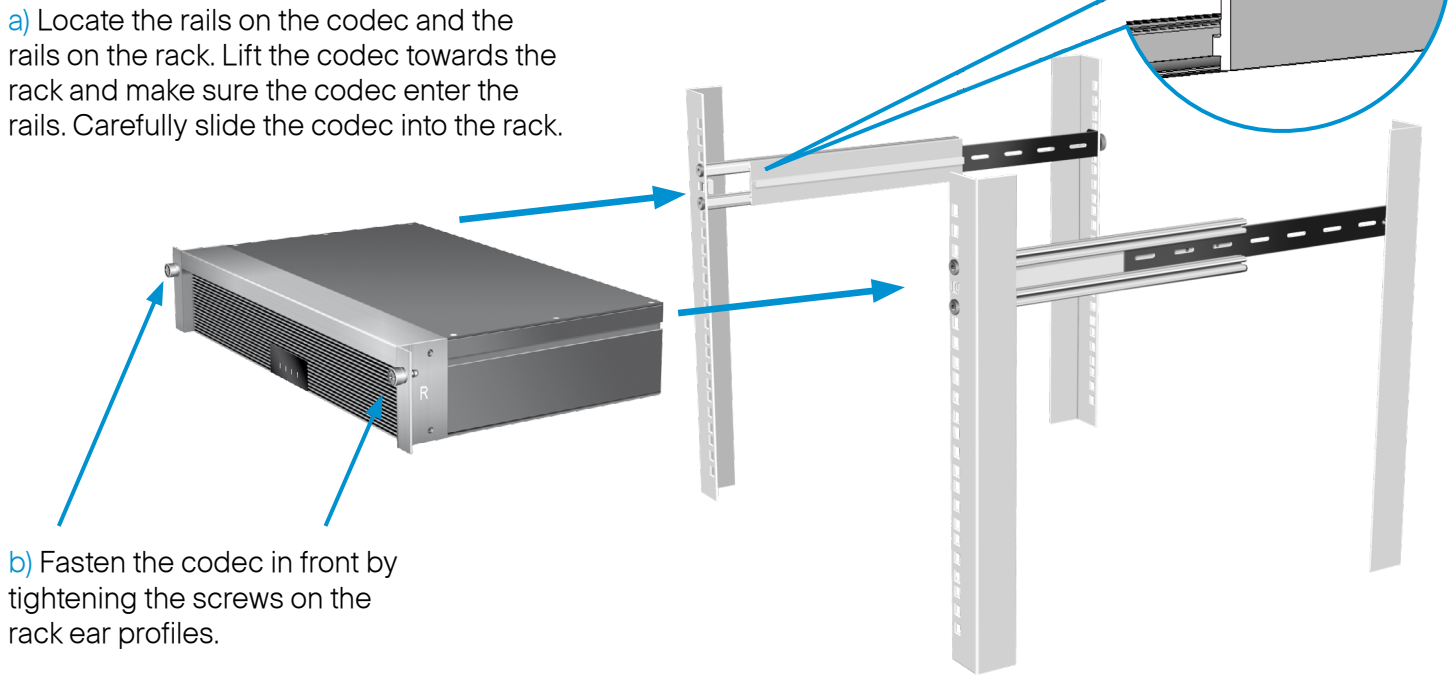

IMPORTANT

There should always be a distance of minimum 10 cm / 4 in. free space in front of the codec.



SAFETY REQUIREMENT

Make sure the codec is not mounted with the front side up or down.

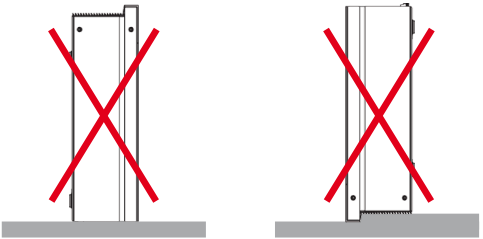

6 Connecting cables

Codec C90 offers a great flexibility in connecting audio and video equipment to the system.

Basic setup - The main connectors are highlighted in orange color.

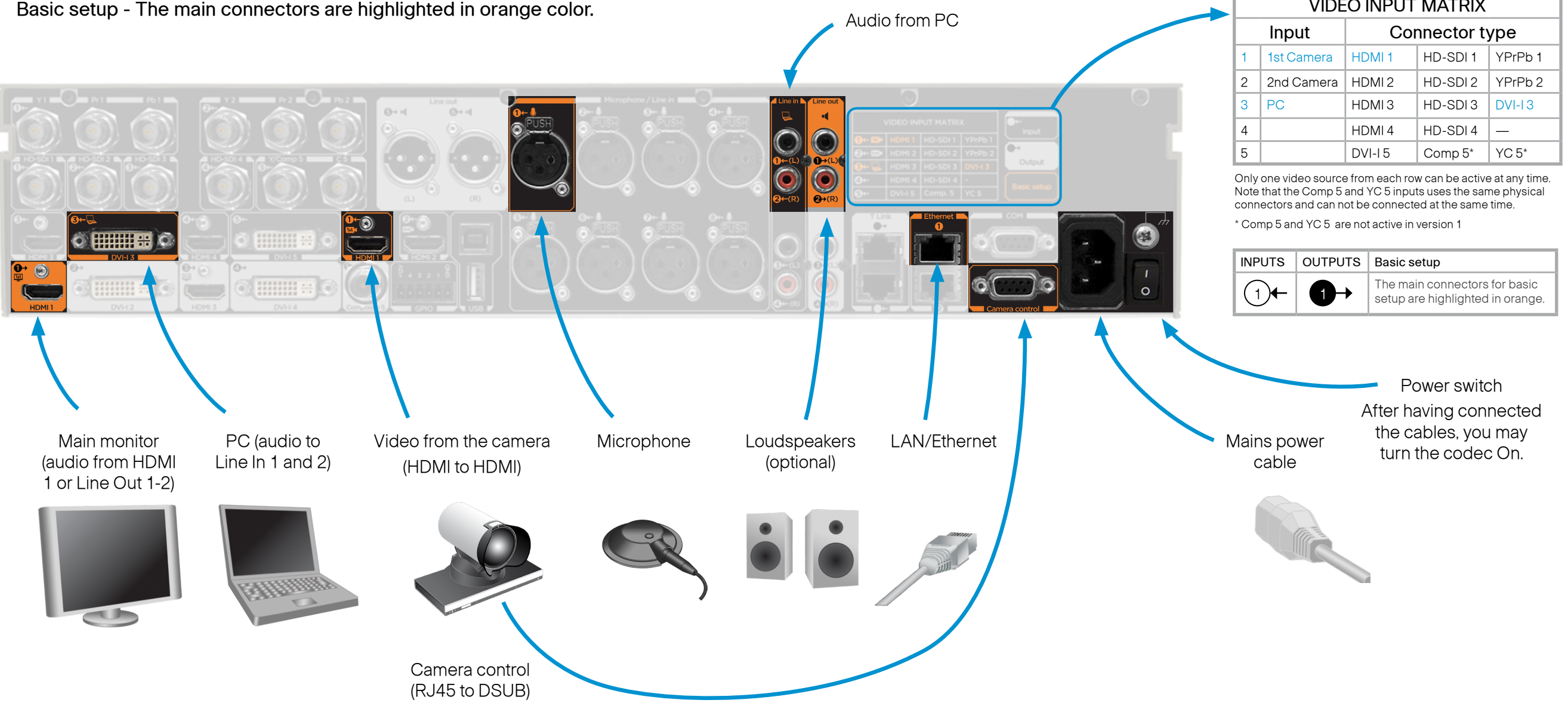

NOTE: If using the DVI-I output (2 or 4) or HDMI 3 for the main monitor a shortcut is required to move the on screen display (OSD) to this output. On the remote control key in the following sequence:

- Disconnect - * - # - * - # - 0 - 2 - # (where 2 represents DVI-I 2)